

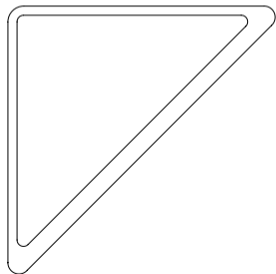

NERO-REED

environexus.com.au/support



① NERO-REED powered by Environexus

The NERO-REED provides your NERO System with the security intelligence required for a modern home automation and security system. And It does it all in a small, elegant design crafted to suit any home's decor.

② Familiarize yourself with your NERO-REED

Package contents:

1. Sensor Unit
2. Back Mounting Plate
3. Magnet Unit (x2)
4. Double-Sided Tape(x2)
5. Screws (x3)
6. USB cable

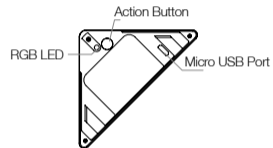
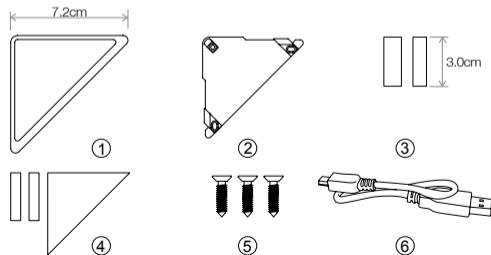

③ Quick start

Installing your NERO-REED

The installation of your NERO-REED has two major steps: the Main Sensor and the Magnet. Your NERO-REED will use wireless technology to talk to your Z-Wave network once paired with your NEXUS-NERO Communications Gateway.

When installing the NERO REED, please ensure:

1. The NERO-REED is installed indoors, away from sources of moisture.
2. The NERO-REED is placed within 20 meters of another Z-Wave device that is either a NEXUS-NERO or 240v devices.
3. The magnet and the main sensor must be less than 1.6cm apart for the small magnet installation or 2.5cm apart for the big magnet installation. Main sensor must be affixed to the door or window and the magnet must be affixed to the frame. The magnet and the main sensor must separate when the door or window is opened.
4. The NERO-REED is not mounted on a metal frame.

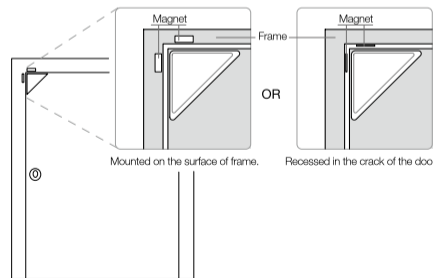

Affix your Back Mounting Plate and Magnet to a surface.

The Back Mounting Plate can be affixed using screws or double-sided tape and should be mounted on the apex angle of the door. The Magnet must be affixed using double-sided tape and can't exceed the valid range, see the figure below.

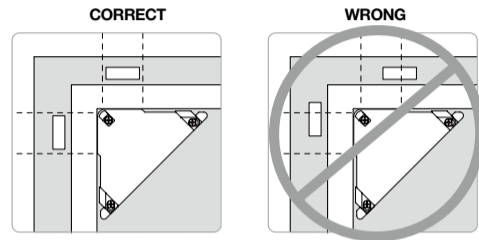

Note:

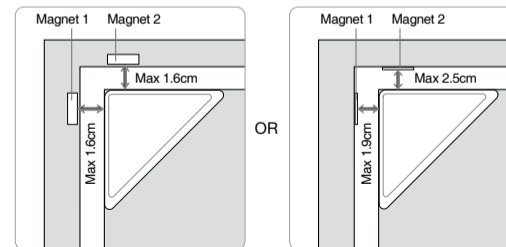

1. There are 2 types of Magnets (Magnet 1: 30mmx6mmx2mm, Magnet 2: 30mmx10mmx2mm), the size of magnet 2 is a little larger than magnet 1, so the magnetism of magnet 2 is stronger than magnet 1.
2. You can choose to install each one of magnet on the door frame according to your need or the distance between the door and frame, see the figure below.
3. Keep Magnets away from children to avoid swallowing.

When the Back Mounting Plate is affixed by the double-sided tape, wipe the two surfaces clean of any oil or dust with a damp towel. When the surface has completely dried, peel one side of the tape back and attach it to the corresponding section on the rear side of the Back Mounting Plate.

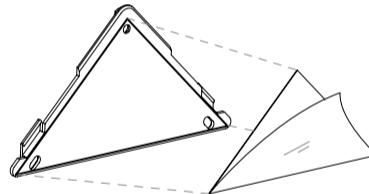

Adding your Sensor to your Z-Wave network

With your mounting plates prepared to hold each component of your sensor, it's time to add it to your NEXUS-NERO.

1. Follow the wizard on the NEXUS-NERO Communications Gateway to sync the NERO-REED.
2. Take your Sensor near to the NEXUS-NERO Communications Gateway.
3. Press the Action Button once on your Sensor. The green LED will blink.
4. If your NERO-REED has been successfully added to your Z-Wave network, its

green LED will be solid for 2 seconds. If the adding was unsuccessful, the red LED will be solid and you will need to repeat the above steps.

With your Sensor now working as a part of your smart home, you'll be able to configure it from your NERO OS.

Attach your Sensor to its Back Mounting plate

With your Sensor added to the Z-Wave network. It's now time to insert the main unit into the corresponding sensor plate.

Put the main unit in the top-left direction on the Back Mounting, and then push the Sensor into the Back Mounting Plate, as the figure below shows.

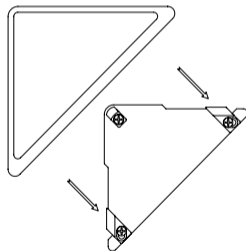

④ Advanced functions

Send a wake up notification

In order to send your Sensor new configuration commands from your Z-Wave controller or gateway, it will need to be woken up.

1. Remove your Sensor unit from its Back Mounting Plate, press the Action Button on the back of the Sensor unit and then release the Action Button. This will trigger and send a wake up notification command to your controller/gateway.
2. If you want your Sensor to keep awake for a longer time, press and hold the Action Button on the back of the Sensor unit for 3 seconds, then your Sensor will wake up for 10 minutes and the orange LED will fast blink while it is awake.

Removing your Sensor from your NEXUS-NERO

Your sensor can be removed from your Z-Wave network at any time. You'll need to use your NERO OS. To do this, please follow the wizard.

1. Follow the NERO OS wizard for the NERO-REED and select RETRY.
2. Unlock your Sensor from the Back Mount plate and take the Sensor unit near to your NEXUS-NERO.
3. Press the Action Button on your Sensor.
4. If your NERO-REED is successfully removed from the Z-Wave network, the RGB LED will become a colorful gradient for a few seconds and then turn off. If the removing was unsuccessful, the RGB LED will be solid for 8 seconds and then turn off, repeat the above steps.

Factory Reset your Sensor

If your NEXUS-NERO is missing or inoperable, you may wish to reset all of your NERO-REED settings to their factory defaults. To do this, press and hold the Action Button for 20 seconds and the green LED will be solid for 2 seconds and then be colorful gradient to confirm a success.

Your Sensor's battery

Your NERO-REED has a internal rechargeable lithium battery that will last on average, 6 months on a full charge. The charger's output should be a micro USB terminal with the specification of output DC 5V/1A. When the Door Window Sensor is in charge state, the orange LED will be on. If the orange LED is off and the green LED remains on, then it indicates that the battery charge is complete.

⑤ Technical specifications

Power supply: Rechargeable Lithium battery, 3.7 V, 500mAh
Battery charger input: Micro USB port, DC 5V±0.5V, max 1A
Operating temperature: 0°C to 40°C
Waterproofing: IP20 (Indoor use only)
Operating distance: 20 meters no obstruction

⑥ Warranty

Environexus warrants to the original purchaser of Products that for the Warranty Period (as defined below), the Products will be free from material defects in materials and workmanship. The foregoing warranty is subject to the proper installation, operation and maintenance of the Products in accordance with installation instructions and the operating manual supplied to the customer. Warranty claims must be made by Customer in writing within thirty (30) days of the manifestation of a problem. Environexus' sole obligation under the foregoing warranty is, at Environexus' option, to repair, replace or correct any such defect that was present at the time of delivery, or to remove the Products and to refund the purchase price to the Customer.

The "Warranty Period" begins on the date the Products is delivered and continues for 12 months.

Any repairs under this warranty must be conducted by an authorized Environexus service representative and under Environexus' RMA policy. Any repairs conducted by unauthorized persons shall void this warranty.

Excluded from the warranty are problems due to accidents, acts of God, civil or military authority, civil disturbance, war, strikes, fires, other catastrophes, misuse, misapplication, storage damage, negligence, electrical power problems, or modification to the Products or its components.

Environexus does not authorize any person or party to assume or create for it any other obligation or liability in connection with the Products except as set forth herein. Environexus will pass on to Customer all manufacturers' Material warranties to the extent that they are transferable, but will not independently warrant any Material.

Customer must prepay shipping and transportation charges for the returned Products, and insure the shipment or accept the risk of loss or damage during such shipment and transportation. Environexus will ship the repaired or replacement products to Customer freight prepaid.

Customer shall indemnify, defend, and hold Environexus and Environexus' affiliates, shareholders, directors, officers, employees, contractors, agents and other representatives harmless from all demands, claims, actions, causes of action, proceedings, suits, assessments, losses, damages, liabilities, settlements, judgments, fines, penalties, interest, costs and expenses (including fees and disbursements of

counsel) of every kind (i) based upon personal injury or death or injury to property to the extent any of the foregoing is proximately caused either by a defective product (including strict liability in tort) or by the negligent or willful acts or omissions of Customer or its officers, employees, subcontractors or agents, and/or (ii) arising from or relating to any actual or alleged infringement or misappropriation of any patent, trademark, mask work, copyright, trade secret or any actual or alleged violation of any other intellectual property rights arising from or in connection with the products, except to the extent that such infringement exists as a result of Environexus' manufacturing processes.

IN NO EVENT SHALL ENVIRONEXUS BE LIABLE FOR ANY INDIRECT, INCIDENTAL, PUNITIVE, SPECIAL OR CONSEQUENTIAL DAMAGES, OR DAMAGES FOR LOSS OR PROFITS, REVENUE, OR USE INCURRED BY CUSTOMER OR ANY THIRD PARTY, WHETHER IN AN ACTION IN CONTRACT, OR TORT, OR OTHERWISE EVEN IF ADVISED OF THE POSSIBILITY OF SUCH DAMAGES. ENVIRONEXUS' LIABILITY AND CUSTOMER'S EXCLUSIVE REMEDY FOR ANY CAUSE OF ACTION ARISING IN CONNECTION WITH THIS AGREEMENT OR THE SALE OR USE OF THE PRODUCTS, WHETHER BASED ON NEGLIGENCE, STRICT LIABILITY, BREACH OF WARRANTY, BREACH OF AGREEMENT, OR EQUITABLE PRINCIPLES, IS EXPRESSLY LIMITED TO , AT ENVIRONEXUS' OPTION, REPLACEMENT OF, OR REPAYMENT OF THE PURCHASE PRICE FOR THAT PORTION OF PRODUCTS WITH RESPECT TO WHICH DAMAGES ARE CLAIMED. ALL CLAIMS OF ANY KIND ARISING IN CONNECTION WITH THIS AGREEMENT OR THE SALE OR USE OF PRODUCTS SHALL BE DEEMED WAIVED UNLESS MADE IN WRITING WITHIN THIRTY (30) DAYS FROM ENVIRONEXUS' DELIVERY, OR THE DATE FIXED FOR DELIVERY IN THE EVENT OF NONDELIVERY. THE INDEMNITY AND WARRANTY IN ABOVE ARE EXCLUSIVE AND IN LIEU OF ALL OTHER INDEMNITIES OR WARRANTIES, WHETHER EXPRESS OR IMPLIED, INCLUDING THE IMPLIED WARRANTIES OR MERCHANTABILITY AND FITNESS FOR A PARTICULAR PURPOSE

Warning

Do not dispose of electrical appliances as unsorted municipal waste, use separate collection facilities.

Contact your local government for information regarding the collection systems. available.