

## ZB5AW333

green flush illuminated pushbutton head Ø22 spring return for integral LED



### Main

|                                 |                                  |
|---------------------------------|----------------------------------|
| Range of product                | Harmony XB5                      |
| Product or component type       | Head for illuminated push-button |
| Device short name               | ZB5                              |
| Product compatibility           | Integral LED                     |
| Bezel material                  | Plastic                          |
| Mounting diameter               | 22 mm                            |
| Sale per indivisible quantity   | 1                                |
| Shape of signaling unit head    | Round                            |
| Type of operator                | Spring return                    |
| Operator profile                | Green flush unmarked             |
| Operator additional information | With plain lens                  |

### Complementary

|                                    |   |
|------------------------------------|---|
| CAD overall width                  | 29 mm   |
| CAD overall height                 | 29 mm   |
| CAD overall depth                  | 30 mm   |
| Product weight                     | 0.017 kg  |
| Resistance to high pressure washer | 7000000 Pa at 55 °C, distance: 0.1 m  |
| Mechanical durability              | 10000000 cycles   |
| Station name                       | XALD 1...5 cut-outs<br>XALK 2...5 cut-outs  |
| Electrical composition code        | M1 for <= 6 contacts using single blocks in front mounting with integral LED<br>M2 for <= 6 contacts using single and double blocks in front mounting with integral LED<br>M10 for <= 2 contacts using single blocks in front mounting with integral LED<br>M6 for <= 2 contacts using single blocks in front mounting with integral LED and transformer<br>MF1 for <= 2 contacts using single blocks in front mounting with integral LED<br>MR1 for <= 2 contacts using single blocks in rear mounting with integral LED |

### Environment

|  |   |
|--|---|
| protective treatment                       | TC  |
| ambient air temperature for storage        | -40...70 °C   |
| ambient air temperature for operation      | -40...70 °C   |
| class of protection against electric shock | Class II conforming to IEC 60536  |
| overvoltage category                       | Class II conforming to IEC 60536  |
| IP degree of protection                    | IP67<br>IP66 conforming to IEC 60529<br>IP69K<br>IP69   |
| NEMA degree of protection                  | NEMA 13<br>NEMA 4X  |
| IK degree of protection                    | IK05 conforming to EN 50102   |
| standards                                  | EN/IEC 60947-1<br>EN/IEC 60947-5-1<br>EN/IEC 60947-5-4<br>JIS C 4520<br>UL 508<br>GB 14048.5<br>CSA C22.2 No 14 |
| product certifications                     | BV<br>CSA<br>DNV  |

The information provided in this documentation contains general descriptions and/or technical characteristics of the performance of the products contained herein. This documentation is not intended as a substitute for and is not to be used for determining suitability or reliability of these products for specific user applications. It is the duty of any such user or integrator to perform the appropriate and complete risk analysis, evaluation and testing of the products with respect to the relevant specific application or use thereof. Neither Schneider Electric Industries SAS nor any of its affiliates or subsidiaries shall be responsible or liable for misuse of the information contained herein.

GL  
LROS (Lloyds register of shipping)  
RINA  
UL listed

|                      |  |
|----------------------|--|
| vibration resistance | 5 gn (f = 2...500 Hz) conforming to IEC 60068-2-6  |
| shock resistance     | 30 gn (duration = 18 ms) for half sine wave acceleration conforming to IEC 60068-2-27<br>50 gn (duration = 11 ms) for half sine wave acceleration conforming to IEC 60068-2-27 |

## Dimensions

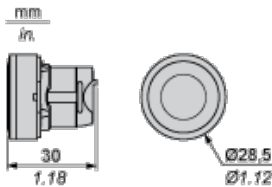

## Panel Cut-out for Pushbuttons, Switches and Pilot Lights (Finished Holes, Ready for Installation)

Connection by Screw Clamp Terminals or Plug-in Connectors or on Printed Circuit Board

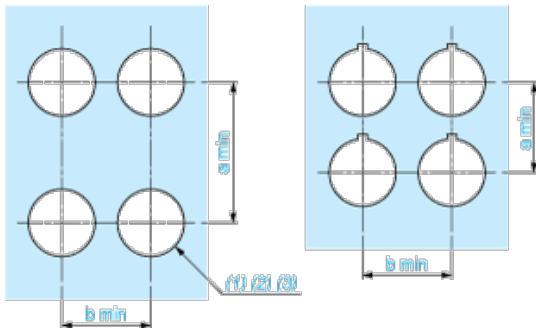

- (1) Diameter on finished panel or support
- (2) For selector switches and Emergency stop buttons, use of an anti-rotation plate type ZB5AZ902 is recommended.
- (3) Ø22.5 mm recommended ( $\text{Ø}22.3_{0}^{+0.4}$ ) / Ø0.89 in. recommended ( $\text{Ø}0.89_{0}^{+0.016}$ )

| Connections                                   | a in mm | a in in. | b in mm | b in in. |
|---|---------|----------|---------|----------|
| By screw clamp terminals or plug-in connector | 40      | 1.57     | 30      | 1.18     |
| By Faston connectors                          | 45      | 1.77     | 32      | 1.26     |
| On printed circuit board                      | 30      | 1.18     | 30      | 1.18     |

## Detail of Lug Recess

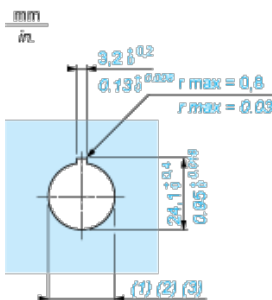

- (1) Diameter on finished panel or support
- (2) For selector switches and Emergency stop buttons, use of an anti-rotation plate type ZB5AZ902 is recommended.
- (3) Ø22.5 mm recommended ( $\text{Ø}22.3_{0}^{+0.4}$ ) / Ø0.89 in. recommended ( $\text{Ø}0.89_{0}^{+0.016}$ )

## Pushbuttons, Switches and Pilot Lights for Printed Circuit Board Connection

**B:** 40 mm min. / 1.57 in. min.

Dimensions in mm

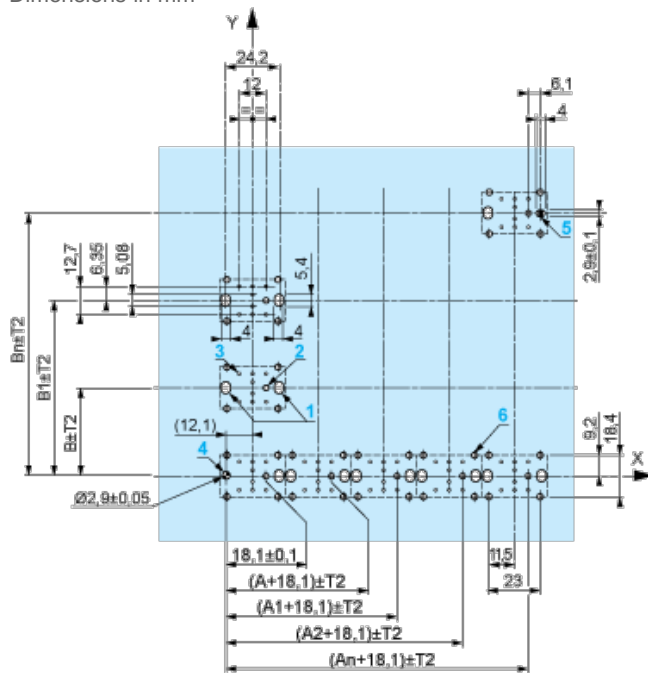

**B:** 40 mm min.

Dimensions in in.

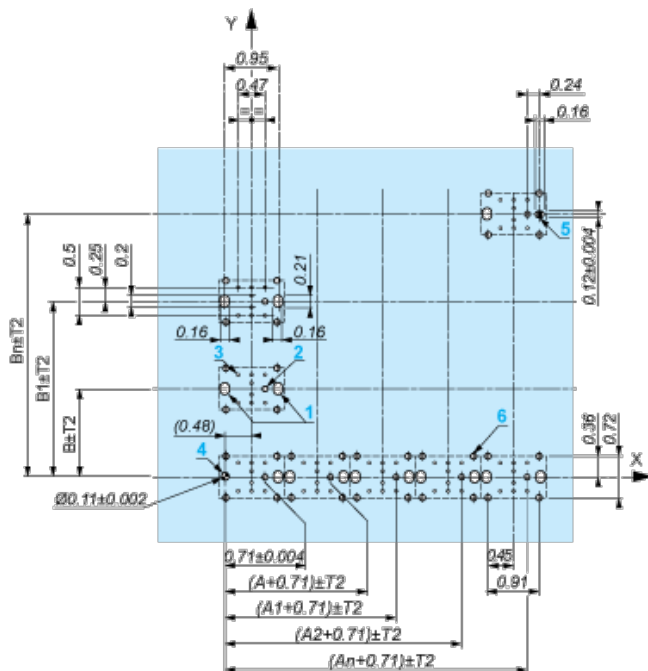

A: 1.18 in. min.

B: 1.57 in. min.

### General Tolerances of the Panel and Printed Circuit Board

The cumulative tolerance must not exceed 0.3 mm / 0.012 in.:  $T1 + T2 = 0.3 \text{ mm max.}$

### Installation Precautions

- | Minimum thickness of circuit board: 1.6 mm / 0.06 in.
- | Cut-out diameter: 22.4 mm  $\pm 0.1$  / 0.88 in.  $\pm 0.004$
- | Orientation of body/fixing collar ZB5AZ009:  $\pm 2^\circ 30'$  (excluding cut-outs marked **a** and **b**).
- | Tightening torque of screws ZBZ006: 0.6 N.m (5.3 lbf.in) max.
- | Allow for one ZB5AZ079 fixing collar/pillar and its fixing screws:
  - | every 90 mm / 3.54 in. horizontally (X), and 120 mm / 4.72 in. vertically (Y).
  - | with each selector switch head (ZB5AD•, ZB5AJ•, ZB5AG•).

The fixing centers marked **a** and **b** are diagonally opposed and must align with those marked **4** and **5**.



- (1) Head ZB5AD•
- (2) Panel
- (3) Nut
- (4) Printed circuit board

### Mounting of Adapter (Socket) ZBZ01•

- | 1 2 elongated holes for ZBZ006 screw access
- | 2 1 hole  $\varnothing 2.4 \text{ mm} \pm 0.05$  / 0.09 in.  $\pm 0.002$  for centring adapter ZBZ01•
- | 3 8  $\times \varnothing 1.2 \text{ mm}$  / 0.05 in. holes
- | 4 1 hole  $\varnothing 2.9 \text{ mm} \pm 0.05$  / 0.11 in.  $\pm 0.002$ , for aligning the printed circuit board (with cut-out marked **a**)

┆ **5** 1 elongated hole for aligning the printed circuit board (with cut-out marked **b**)

┆ **6** 4 holes Ø 2.4 mm / 0.09 in. for clipping in adapter ZBZ01•

Dimensions An + 18.1 relate to the Ø 2.4 mm ± 0.05 / 0.09 in. ± 0.002 holes for centring adapter ZBZ01•.